



09/2013 S2TRGB131S01

Our policy of constant technological upgrading means that technical specifications may be subject to change without prior notice.



S220TR

Versatility at its very best

Sede Legale ed Amministrativa / Head Quarter
CEFLA s.c.
Via Selice Prov.le, 23/a
40026 Imola (BO) - Italy
Tel. +39 0542 653111
Fax +39 0542 653344



Fabbricatore / Manufacturer
Cefla Dental Group
Via Bicocca, 14/C - 40026 Imola (BO) - Italy
Tel. +39 0542 653441 - Fax +39 0542 653601
www.sternweber.com
sternweber@sternweber.com





STERN S220TR **INTERNATIONAL**



STERN S220TR **CART**



STERN S220TR **HYBRID**



STERN S220TR **SIDE DELIVERY**





YOUR NEEDS ARE OUR GOALS

Offer yourself what you're really after

The Stern Weber dental unit is moulded around the needs of those who work with it, so whatever your operating style we provide a highly practical solution to suit *you*. For those seeking cutting-edge performance, we've developed technologically advanced devices and instruments. For those who demand uncompromising safety, we offer a wide range of tried and tested hygiene systems. And to those intending to optimise workflows, we dedicate smoothly integrated multimedia and X-ray diagnosis systems.

The result is an integrated treatment centre that, from all standpoints, offers innovation, outstanding reliability and performance levels suited to every possible need. This is the Stern Weber world, and you stand at the centre of it.

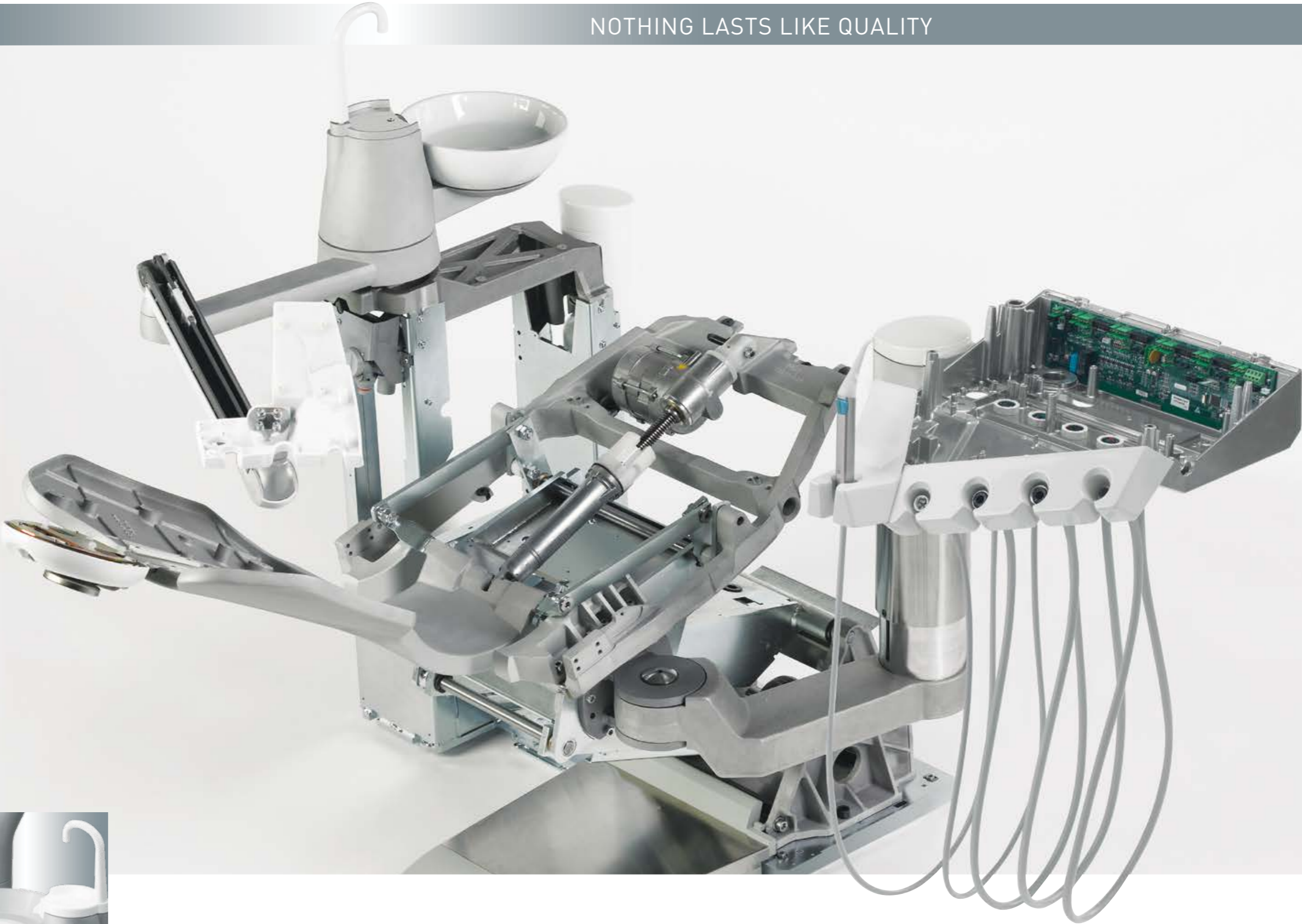

Instrument recall levers are made of nylon.



The velvet-finish tempered glass cuspidor bowl is also available in ceramic.

Building a future requires solid foundations: that's why a Stern Weber dental unit always ensures stability and structural strength. Aluminium alloy castings provide enhanced strength. Special glass, ceramic, nylon and plastic materials provide resistance to chemical aggression. Moreover, a reinforced patient chair structure allows patients weighing up to 190 kg to be lifted. Each dental unit is subject to a complete final test, documented during working scenario simulations. Strict production criteria ensure maximum dental unit quality and reliability, always.



Continental



International



Side Delivery



The dentist's module arm features an optional pneumatic brake. Activated via the button on the handle, this device allows precise height adjustment at the click of a switch.



Chair with cuspidor
A version without a dentist's module is also available, allowing configuration of the 5-holder assistant's module with a dynamic instrument or with the camera.



Assistant's module assembled on jointed arm, which also features extensive vertical adjustment.

Classic and innovative ergonomics. Six models that cover a vast range of dentistry needs. For dentists who operate in indirect vision mode, the **International** model provides a solution that is as comfortable as it is flexible. **Side Delivery**, with an adjustable dentist's module installed on a cast aluminium metal support structure, ensures outstanding stability while the **Cart** provides full freedom of movement. The **Continental** provides optimal instrument manoeuvrability and a pantograph arm that passes over the patient for hindrance-free positioning, while the **Hybrid** model offers absolute versatility as it can be used by both right and left-handed dentists.



Available exclusively as a Continental model, the S220TR HYBRID features a repositionable instrument control panel that completes module transformation when configured for left-handed dentists.

All that needs to be done is to detach the instrument control panel, rotate the quick coupling 180° and then reposition the former on the opposite side of the module.

Much more than just an ambidextrous model, the S220TR HYBRID is an explosion of versatility. The dentist's module rotates 340° to reach positions all around the patient while the assistant's module can be shifted right or left and remains independent from dentist's module rotation. Exceptional operating freedom whether working alone or with an assistant.



Atlasis
Another available option on the S220TR is the Atlasis pneumatic headrest, which can be positioned without mechanical levers or brakes. Using just one hand, the dentist can release the headrest and reposition it comfortably, gently accompanying the movements of the neck joint. In addition, the headrest vertical movements can be adjusted via the support rod.



Special patient chair shaping makes it easier for staff to get in close to the operating zone; also features Trendelenburg movement and a 190 kg lift capacity.



Memory Foam
Optional Memory Foam padding ensures greater patient comfort and relaxation. Available in 7 colours.



T9 Stool
An ergonomic stool for both dentist and assistant. Designed to suit all builds, it features adjustable tilt and height plus good lumbar support.



On the Side Delivery model the dentist's module remains behind the backrest when patients access to the chair, therefore remaining outside their field of vision.

Each specific component is designed with the same conscientiousness that Stern Weber dedicates to continuous research, providing solutions that evolve together with the needs of the dentist. In addition to ergonomics, the comfort factor is of prime importance, because a patient at ease enhances the working effectiveness of the medical staff.



- Venus Plus - L LED**
- Light intensity from 3,000 to 50,000 Lux
 - Adjustment via potentiometer or no-touch sensor
 - Colour temperature: 5,000 K
 - 3-axis rotation
 - Low-thermal emission LED light sources
 - LEDs guaranteed to work 50,000 hours



- Venus Plus**
- Light intensity from 8,000 to 35,000 Lux
 - Potentiometer and soft-start device
 - Colour temperature: 4,900 K
 - 3-axis rotation



Power Pedal Foot Control

Foot controls also allow users to operate the Chip Air and Chip Water functions that trigger an air or water jet to the instrument.



Pressure-operated Foot Control

With the instrument extracted micromotor rotation can be inverted and the operating light switched on.



Multi-function Foot Control

In surgery mode it's also possible to open and close the peristaltic pump.

A key aspect of the Stern Weber philosophy is that of leaving dental unit personalisation to the dentist, allowing him to express his professionalism in full. Not just in terms of ergonomic configurations and colour schemes, but also as regards hygiene systems, instruments, foot controls and operating lights. Because the Stern Weber world is your world.



The assistant's module incorporates controls for movement of the patient chair, switching on the operating light and the water to cup and cuspidor bowl rinse functions.



As an option, the assistant's module can also incorporate an add-on unit for camera and T-LED light.

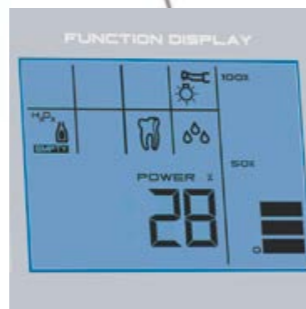

The instrument control panel can be used not only to read data, but also adjust micromotor speed (effective rpm) and power (expressed as a percentage) where a turbine and scaler are installed.

Easily read, the data shown on the large LCD display concerns instrument parameters and dental unit operating status. Icons for control of patient chair, main instrument settings, systems and accessories are arranged on the keypad logically and intuitively.



SC Scalers
Indicated for supragingival prophylaxis tasks of the periodontal type and for the preparation of small cavities and in endodontic root canal cleaning techniques. Power levels are shown on the display.

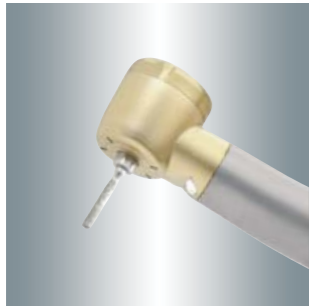

Silent Power Turbines
Powerful yet particularly silent instruments for multiple irrigation with separate nozzles, LED lighting and button-operated release for bur changeover.



i-XR3 / i-XR3L
The induction technology on this micromotor cuts maintenance needs to a minimum. Suitable for conservative and prosthetic dentistry, the micromotor can be cold-disinfected. On the 3L version LED lighting is also incorporated.

- Torque up to 3 Ncm
- Speed range from 1,000 to 40,000 rpm
- Dimensions: Ø22 x 35.1 mm
- Weight: 82 g

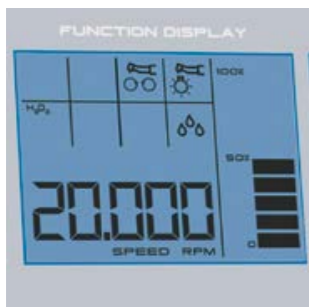

Micromotor parameters - speed, spray feed, light - are presented via numerical data and user-friendly icons.



Tubing on both dentist's and assistant's modules can easily be replaced via the quick couplings.

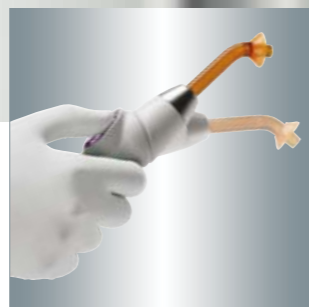

T-LED
Features 6 programmes for polymerisation and bonding tasks. Depending on the programme, delivered energy ranges from 11,250 mJ to 36,000 mJ. A special key on the control panel reduces operating light intensity to a level that prevents interference with composite polymerisation.



The extensive range of exclusive instruments means that Stern Weber offers nothing less than the very best performance. Dentists can configure the dental unit in the knowledge that sophisticated, reliable electronics provides complete integration of instruments, allowing them to place complete trust in the tools at their disposal and so express their skills in full. On each version (except for S220TR Hybrid), it's also possible to complete the dentist's module with an optional sixth instrument: camera or curing light.



RXDC HyperSphere
DC X-ray unit with integrated 30 cm collimation, designed for digital radiology. Provides pin-sharp images thanks to a focal spot of just 0.4 mm.



A spherical ball-joint and a lock/release mechanism activated by 2 touch-sensitive areas on the tube head ensure that positioning is both fast and precise.



The handheld wireless control device features 4 keys to adjust exposure and another key to take the X-ray. The RXDC automatically calculates the correct exposure on the basis of the selected anatomic area.



Zen-X
X-ray sensor integrated on the dentist's module. Well-built, ergonomic and available in two sizes, contains a CMOS sensor for high resolution images.

Stern Weber offers you a solution of outstanding practicality and versatility: the X-ray system integrated on the dental unit. Not just any system but a set of cutting-edge devices, each created around new technologies that boost your diagnostic capabilities. Consisting of an X-ray unit with wireless control, digital sensor and medical-grade LED monitor, the integrated X-ray diagnosis system eliminates all the inconveniences associated with separate equipment installation.



C-U2
Excellent brightness, no manual adjustment required, vibration-free freeze frame images. All thanks to the microprocessor incorporated in the handpiece and Progressive Scan technology.



C-U2 PRO
Three different focal adjustments: Macro, Intra-oral and Extra-oral. An ergonomic, versatile digital camera designed to meet all your image-based communication needs.



19" LED Monitor
CE 93/42 certified, the 16:9 monitor comes complete with a lead for connection to the PC. LED light sources ensure outstanding contrast and brightness. A touch-screen version is also available.



For the touch-screen version the optional double-articulated arm is recommended to move the screen in closer or further away from the operating zone. The screen is also tilt-adjustable.

Being able to provide a clear explanation of treatment and illustrate the achieved results provides a simple way of reassuring patients and strengthening their trust in the dentist. Such tools are equally reassuring for the dentist, who can count on the extremely practical technology of Stern Weber multimedia devices. Perfectly integrated with the dental unit electronics, the high performance digital cameras and 19" flat screen monitor are extremely simple to use and provide instantaneous communication with patients.



Automatic Chip Air
This system, featured as standard, automatically emits an air jet when you stop using dynamic instruments so as to clean any residual liquids or solids from the handpiece.

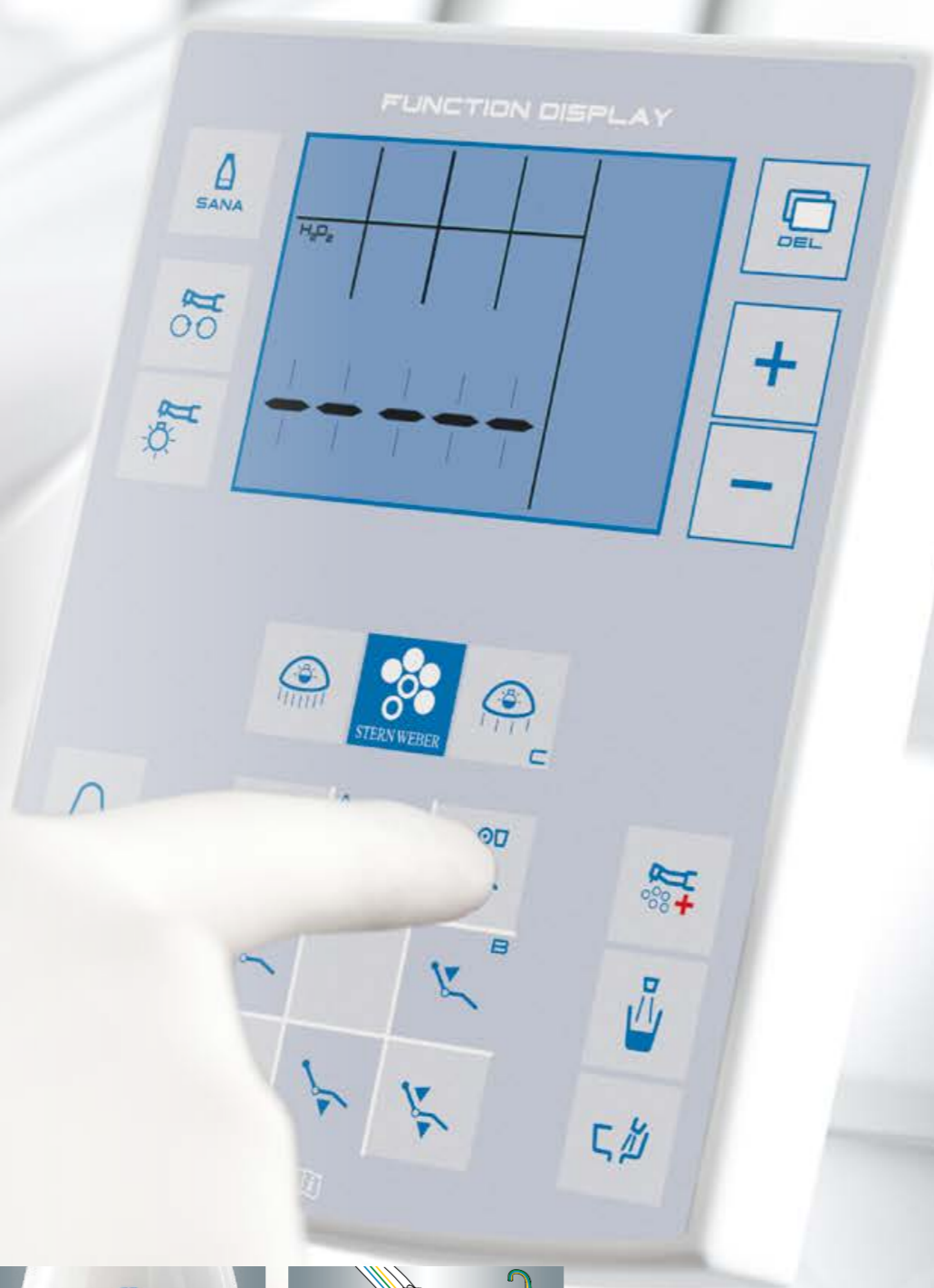

W.H.E. (Water Hygienisation Equipment)
A combination of a continuous disinfection system and a device that ensures an air gap between the mains water circuit and dental unit water circuits. The microbiological quality of the water inside the dental unit is guaranteed by utilisation of **Peroxy Ag+**, a disinfectant even more effective than hydrogen peroxide. At the concentration recommended by Stern Weber, this substance acts effectively against all species of water-borne contaminants such as bacteria, including Legionella, for which just 10 minutes of contact is sufficient.



SANASPRAY S
Distilled water can be used by bypassing the mains water. To carry out rapid circuit sanitisation a second tank is available. Given its tried and tested effectiveness, the use of **Peroxy Ag+** disinfectant is recommended.



A.C.V.S.
Automatic system that carries out suction system sanitisation cycles between one patient and another.

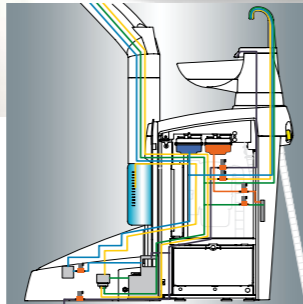

- BIOSTER S
- W.H.E.
- SANASPRAY S
- A.C.V.S.
- Mains water

When we design a Stern Weber product, we certainly don't let our guard down when it comes to hygiene. For us, protecting dentists, assistants and patients from the risks of cross-contamination is more than a practical, conscious decision - it's a duty. Which is why Stern Weber offers hygiene devices of scientifically proven effectiveness. All you have to do is choose the desired level of protection.

Semi-automatic system controlled via the dentist's instrument control panel. Using the special liquid disinfectant tank, **BIOSTER S** disinfects the spray circuits.

The **I.W.F.C.** device ensures effective cleaning of dental unit water circuits after a period of machine idleness.



In addition to the active system, dental unit design also features numerous removable elements such as cuspidor bowl and upholstery, plus surfaces that are easily sanitised.



The instrument holder panel is removable and the soft, silicon instrument mat is both removable and autoclavable.



Extensive filtration surface area on the double filters ensures maximum efficiency and reduces emptying frequency. Independent filter selection is available as an optional function.



Holder guides provide support during extraction and replacement of the suction cannulae. The roller housing can easily be removed for disinfection and cleaning purposes.



The cannulae terminals, like other elements on the dental unit, are removable and autoclavable.



Dentist's and assistant's module feature disposable covers.

CONFIGURATIONS AND COLOURS

S220TR	SIDE DELIVERY	INTERNATIONAL	CART	CONTINENTAL	CHAIR WITH CUSPIDOR	HYBRID
HYGIENE SYSTEMS						
BIOSTER S	*	*	*	*	-	*
A.C.V.S.	*	*	*	*	*	*
SANASPRAY S	*	*	*	*	*	*
W.H.E.	*	*	*	*	*	*
I.W.F.C.	*	*	*	*	-	*
DENTIST'S MODULE						
Micromotor i-XR3L with f.o. (1,000 – 40,000 rpm)	●	●	●	●	-	●
6-way syringe	●	●	●	●	-	●
Sixth instrument	*	*	*	*	-	-
X-ray viewer for panoramic X-rays	*	*	*	-	-	-
Integrated sensor	*	*	-	*	-	*
UNIT BODY						
Glass cuspidor bowl	●	●	●	●	●	●
Ceramic cuspidor bowl	*	*	*	*	*	*
Cuspidor bowl drive	*	*	*	*	*	*
Cup water heater	●	●	●	●	●	●
Spray heating	*	*	*	*	-	*
Independent cannulae selection	*	*	*	*	*	*
Assistant's module dynamic instrument (turbine, scaler or i-XR3)	-	-	-	-	*	-
Suction stop device on chair base	●	●	●	●	●	●
Multimedia applications wiring	*	*	*	*	*	*
Professional tray-holder	*	-	*	-	*	-
Assistant's tray-holder	*	*	*	*	*	-
Venus Plus-L LED operating light	*	*	*	*	*	*
PATIENT CHAIR						
Atlaxis headrest	*	*	*	*	*	*
Mobile, removable right armrest	*	*	*	*	*	*
Left armrest	●	●	●	●	●	*
Child's cushion	*	*	*	*	*	*
Multi-function foot control	●	●	●	●	*	●
Pressure-operated foot control	*	*	*	*	*	*
Power Pedal foot control	*	*	*	*	*	*
Multi-function (wireless) foot control	*	*	*	*	-	*
Pressure-operated foot control (wireless)	*	*	*	*	-	*
Full seat cover for patient chair	*	*	*	*	*	*

● as standard * optional - not available

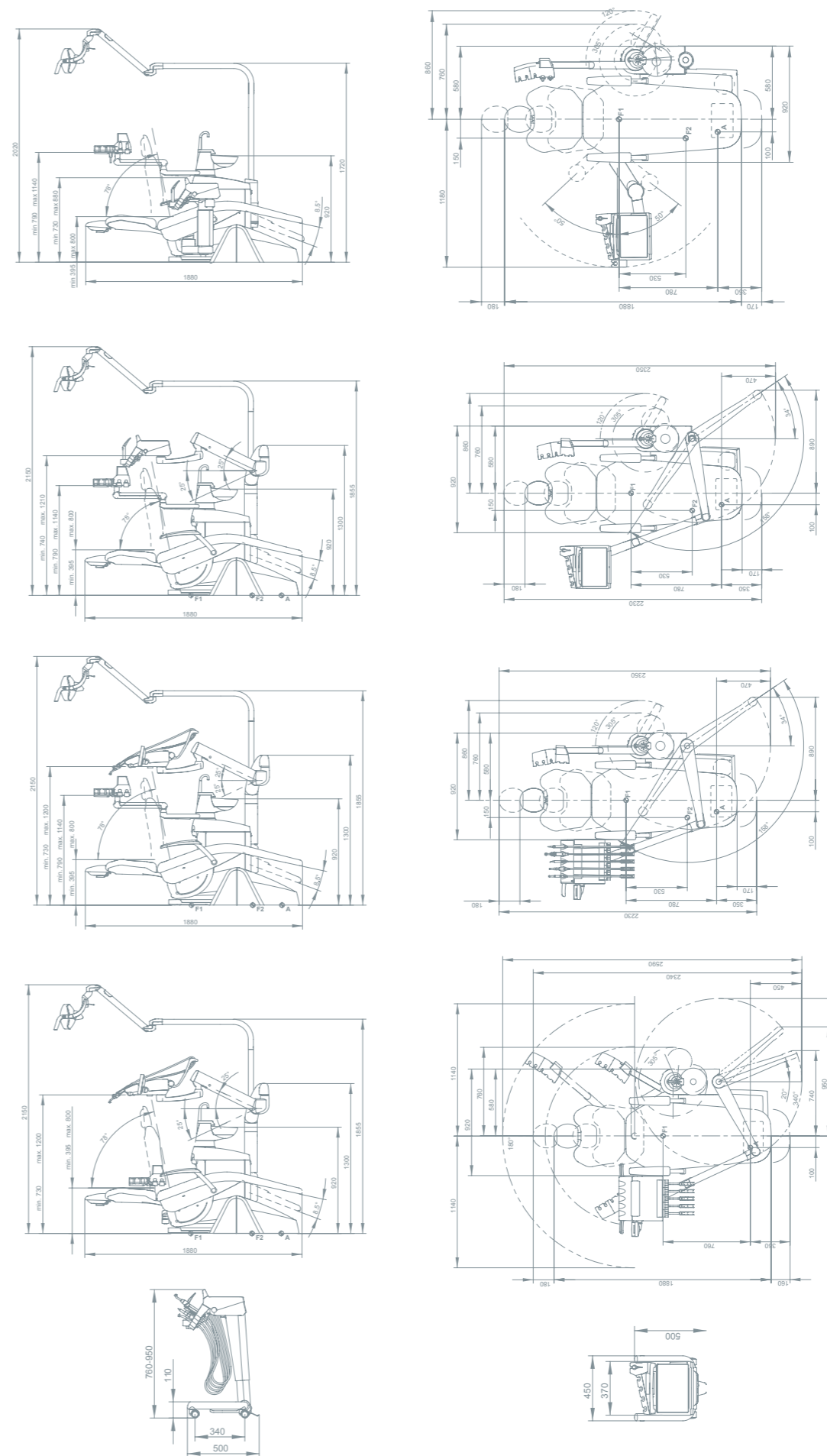

Dimensions are quoted in millimetres.

SIDE DELIVERY

INTERNATIONAL

CONTINENTAL

HYBRID

CART